

Specification Sheet Model L225

- Suspension Type:** Trailing Arm.
- Axle Type:** Non-Steer, 5" round. Available in straight, 6" drop, or 9" drop axle, 71.5" or 77" track width.
- Axle Position:** Pusher or Tag
- Total Axle Travel:** 9.00"
- Suspension Capacity:** 22,500 lbs
- Weight:** 580 lbs installed (less axle)
- Air Controls:** Optional in-cab or all-weather external manual control.
- Brakes:** 16.5" x 7" and 12.25" x 7.5" S-cam type with automatic slack adjuster
- Standard Features:**
- Ride Height: 10.5"
 - Rebound: 3.0"
 - Lift: 6.0"
- (Note: Rebound and Lift are based on ride height dimensions and tire static loaded radius dimensions equaling loaded ground to bottom of frame dimension)
- Wheel Mount Types:**
- Hub piloted
 - Stud piloted (ball seat)
 - Three, Five, and Six spoke

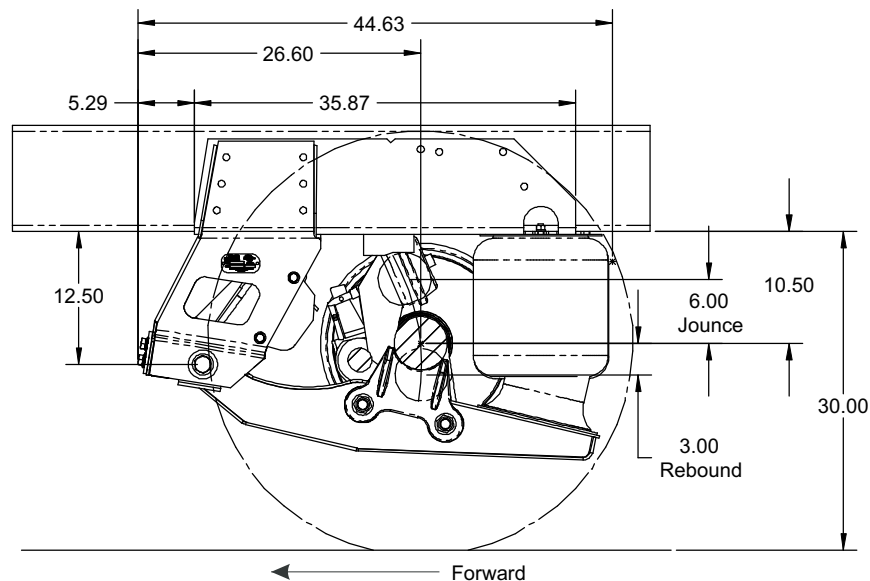

Brookston, IN USA
Mt. Vernon, MO USA
Grimsby, ON CAN

To place your next ReycoGranning® order or for more information on the specification or installation of a ReycoGranning® suspension, call the customer service number at 1-800-255-7824.

www.reycogranning.com

Tuthill Transport Technologies reserves the right to change this information without notice. Information contained herein is general in nature and not intended for specific application purposes.

L225

Lift Air Ride Air Lift Suspensions

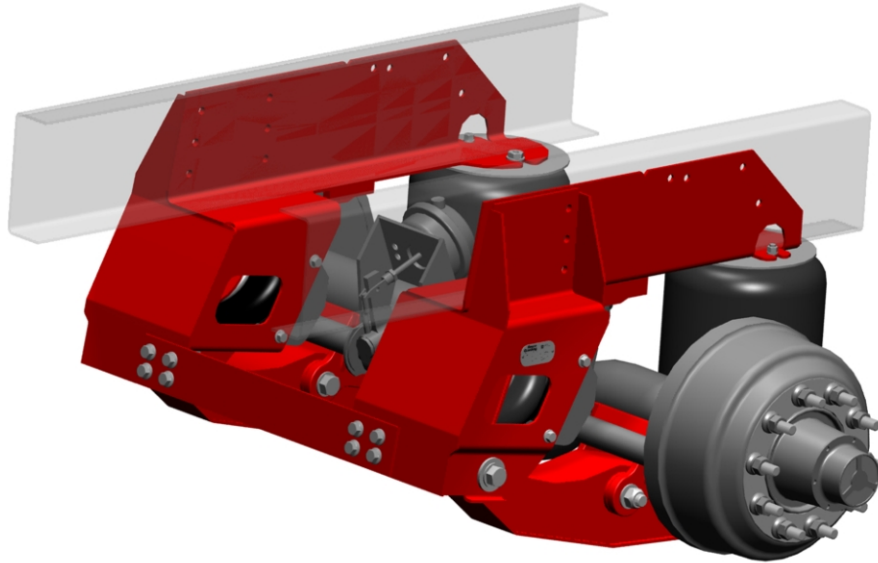

Suspension Capacity Rating

Up to 22,500 lbs.

Applications

Dump Trucks
Construction Vehicles
Refuse Vehicles
Straight Trucks
Transit Mixers
Block Haulers

Features and Benefits

- Durable suspension design maximizes payload capacity.
- Air ride/air lift provides holding and extra-smooth operation.
- Preassembled, compact unit ready for fast and easy limited-space installation.
- Bolt-on crossmember for more flexibility.
- Axle alignment slot simplifies installation process.
- Available in pusher, 6" or 9" drop tag and steerable models.



TUTHILL
Transport Technologies

Brookston, IN USA
Mt. Vernon, MO USA
Grimsby, ON CAN

Reyco
Granning
S U S P E N S I O N S

1-800-255-7824
www.reycogranning.com